



# Quality Modular Buildings

In stock for hire or to purchase  
Q1 2026

# What We Do

We are Algeco. The market-leading UK provider of modular and portable space solutions.

## Our purpose

Together, we build sustainable futures.

## Almost 60 years of hire solutions

We've been helping organisations solve their temporary space challenges quickly, easily and cost-effectively for 60 years.

## A huge product range

We can provide everything you need – from a single storage unit for a few weeks, to hiring large multi-storey open-plan offices, to buying a state-of-the-art £multi-million architecturally designed permanent building. Plus, all our accommodation solutions are available as turnkey packages with internal and external facilities, so all you have to do is move in!

## The Algeco Range



# Why Algeco?

Save time, hassle, and expense managing multiple suppliers. Our hire products are available instantly nationwide, with quick, hassle-free installation.



## Turnkey Solutions

Our turn-key services provide all the exterior and interior facilities you need for your project through one point of contact.



## Best Value

Through economies of scale, our products and services balance quality to offer you the best value possible.



## Availability

With over 40,000 portable and modular units for rent in the UK, we have the best product availability on the market.



## UK-Wide Service

With locations throughout the UK, we can deliver and install your portable buildings directly to your site, no matter where you are.



## Health and Safety

Leading safety practices on both customer sites and throughout Algeco operations.



## ESG and Sustainability

Comprehensive strategy, equality, diversity & inclusion and social responsibility are at the core of our values.





# Strength in Depth

## Algeco is part of the Modulaire Group

Europe & Asia Pacific's leading business service company specialising in modular space.

-  23 countries with operations in Europe and Asia Pacific
-  5100 employees around the world
-  330,000 modular space and storage units
-  180 depots and branches
-  56,000 customers globally in diverse end markets

## Algeco UK Limited

-  1,200 employees within the UK
-  80,000 units ranging from containers to multi-storey buildings
-  Branches covering the whole of the UK in four regions



### **Complete site set up through one point of contact**

Building structures are only part of Algeco hire solutions. Our one-stop-shop provides all the interior and exterior details of your temporary building hire, installed and ready to go.

### **Whole solutions, not just building shells**

Avoid juggling multiple suppliers, purchase orders and invoices. Arrange everything from fencing and furniture to fire safety equipment and white goods before your accommodation arrives.

We can even supply Wi-Fi data, display your branding on the outside of your building and keep consumables like hand sanitiser stocked up.







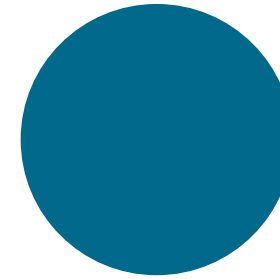
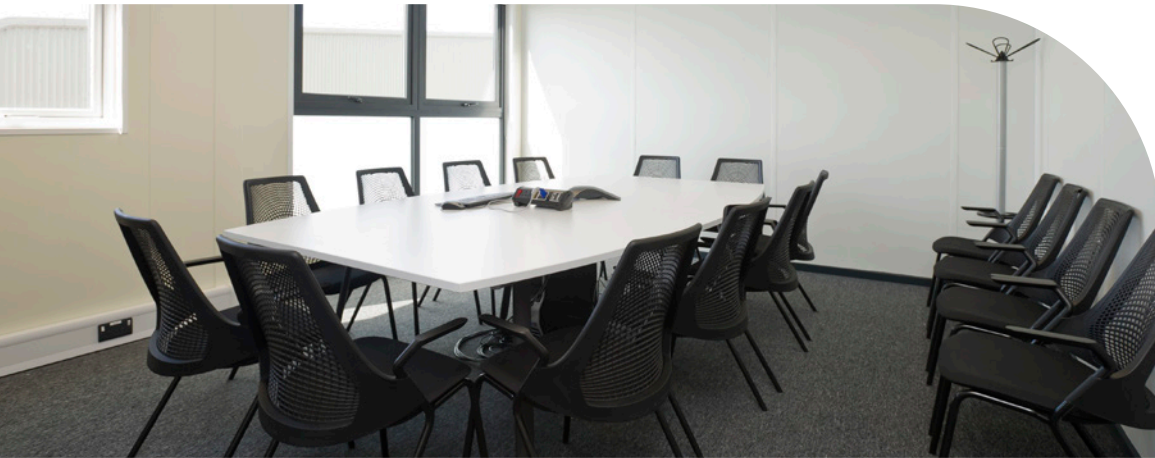













### **Make life easier**

Sourcing everything you need from one provider means you and your teams can get to work faster with less hassle. It also means you spend less time coordinating and communicating with suppliers, which results in fewer moving parts on-site.



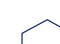

Here's a selection of interior and exterior products and services we can include with your temporary accommodation.

-  **Building Regulations Compliance**
-  **Site Surveys**
-  **CDM Regulations Compliant**
-  **Foundations**
-  **Data Systems**
-  **Fire & Intruder Alarms**
-  **Principal Designer / Principal Contractor**
-  **Climate Control Systems**
-  **Ventilation Systems**
-  **Renewable Technologies**
-  **BREEAM Compliant**
-  **Enabling Works**
-  **Design Services**
-  **Building Management Systems**
-  **BIN Models Available**
-  **Temporary Accommodation**
-  **Steps, Staircases & Ramps**
-  **Access Control Systems**
-  **HTM / HBN / Building Bulletins Compliance**
-  **White Goods**
-  **Wi-Fi Data**

# The Versatile Option

All of our stock buildings can be prepared for a variety of applications:

- Office Accommodation
- Welfare/Canteen Accommodation
- Health Centres/Temporary Wards
- Classroom Accommodation

Algeco modular buildings (for hire) met the relevant Building Regulations at the time of manufacture, so achieve Building Control approval for public use.



# Office Accommodation



# Single-Storey Office Building

Ref: PCL300

Dimensions: 12m x 9m

Number of modules: 3

Overall size: 108m<sup>2</sup>

Single-storey office building comprising of open plan office space, meeting room, kitchen area & toilets.

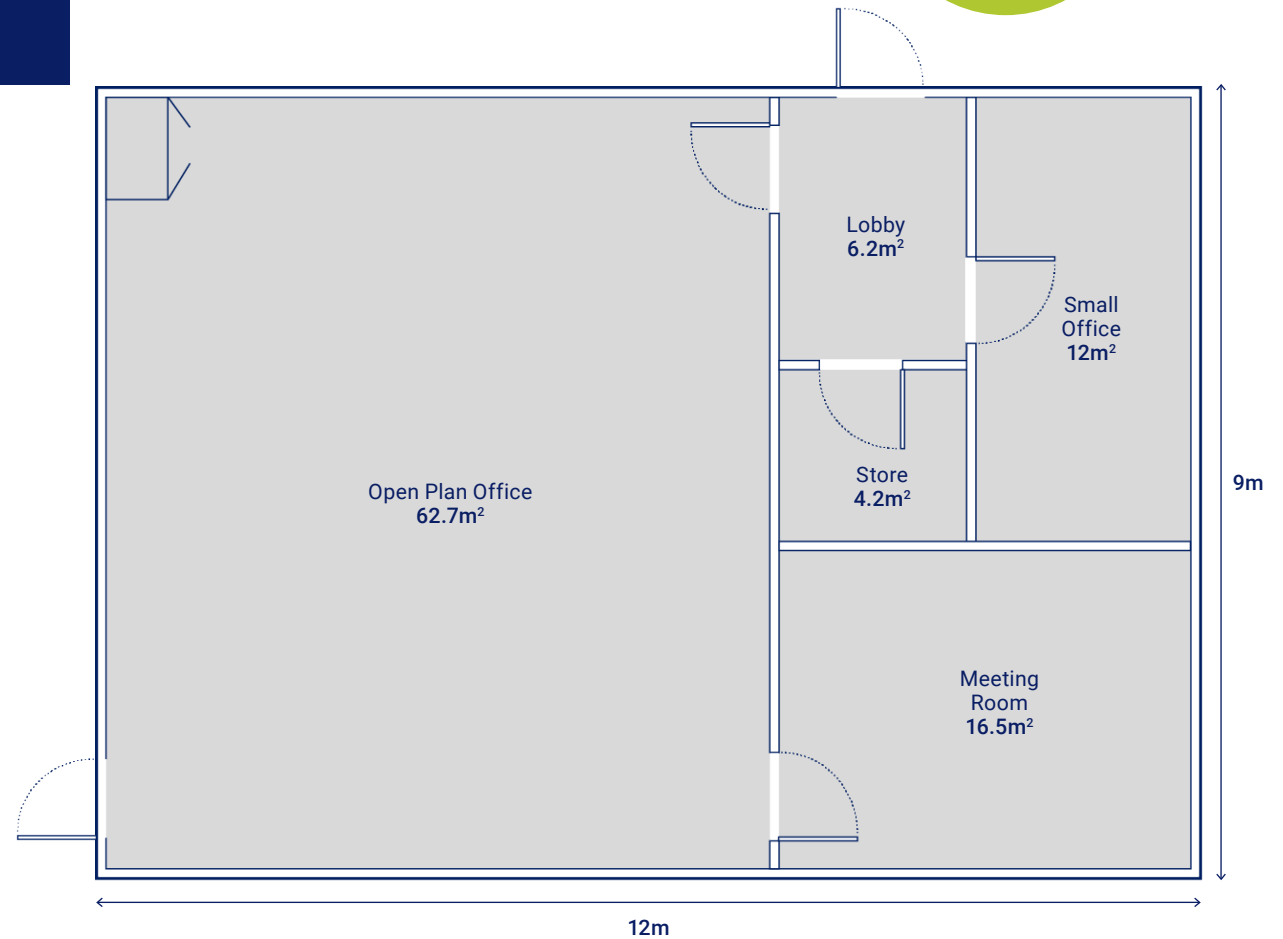

# Two-Storey Admin Building

Ref: SL0060

Dimensions: 12m x 7.2m

Number of modules: 8

Overall size: 173m<sup>2</sup>

Two-storey office building consisting of offices, kitchenette, store rooms and toilets.

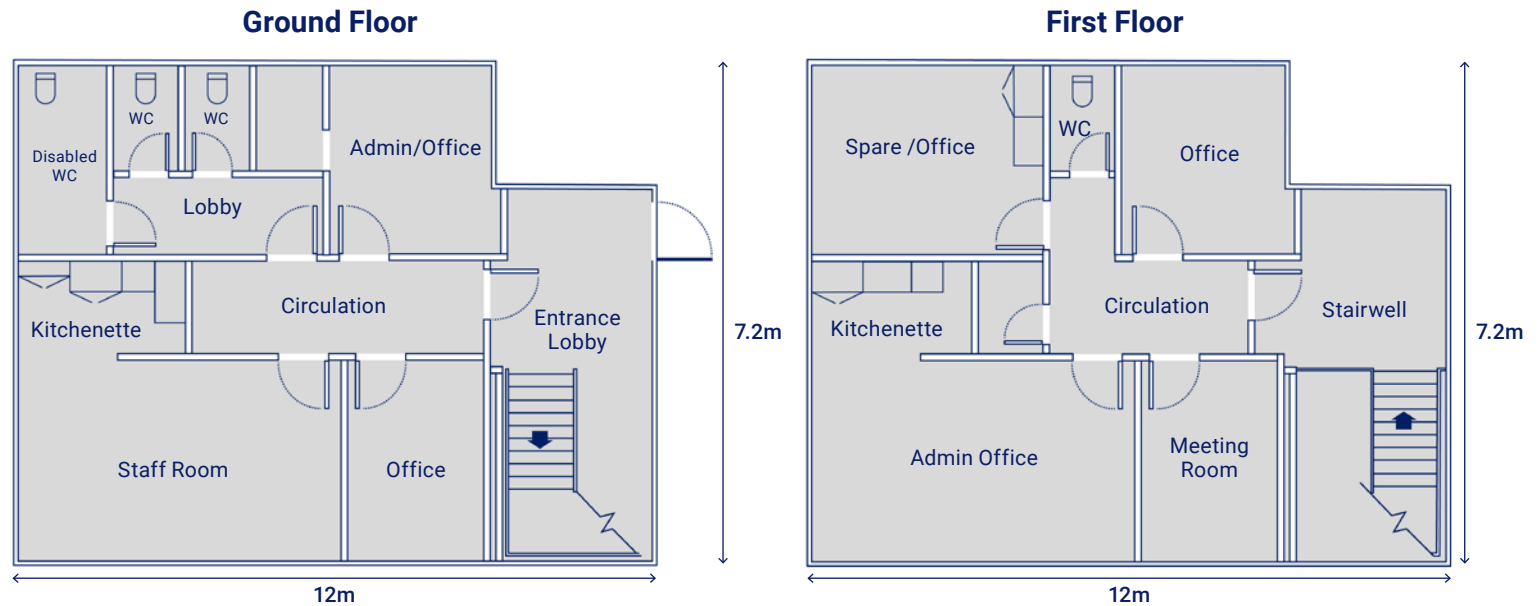

# Single-Storey Multi use Building

Ref: PCL0332

Dimensions: 18m x 10m

Number of modules: 6

Overall size: 180m<sup>2</sup>

Single storey building comprising of large open plan room, including 4 rooms for offices/meeting rooms and 2 rooms for changing rooms.

The building has been designed in line with building regulations.

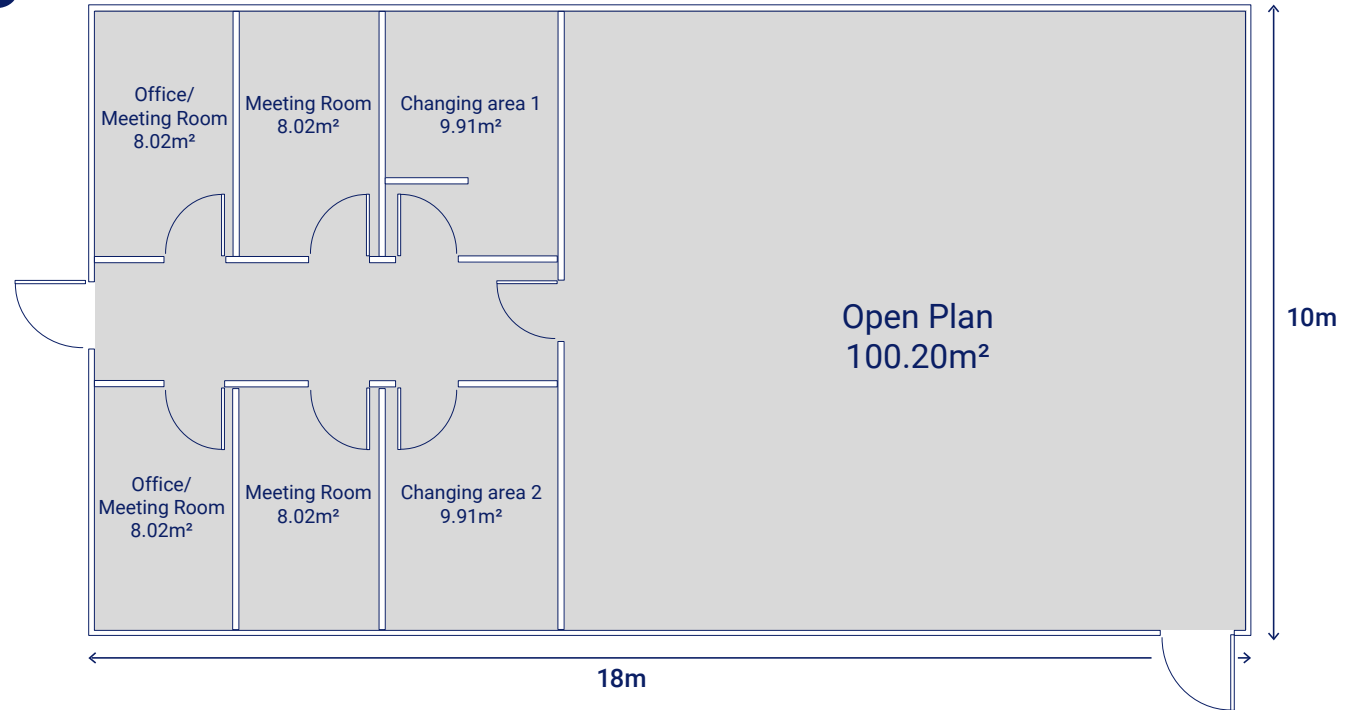

# Single-Storey Office & Welfare Building

Ref: PCL0331

Dimensions: 21.8m x 12.4m

Number of modules: 6

Overall size: 270.3m<sup>2</sup>

Single-storey building comprising of a large open plan office with lobby and kitchen area together with male and female toilet facilities.

The building has been designed in line with building regulations.

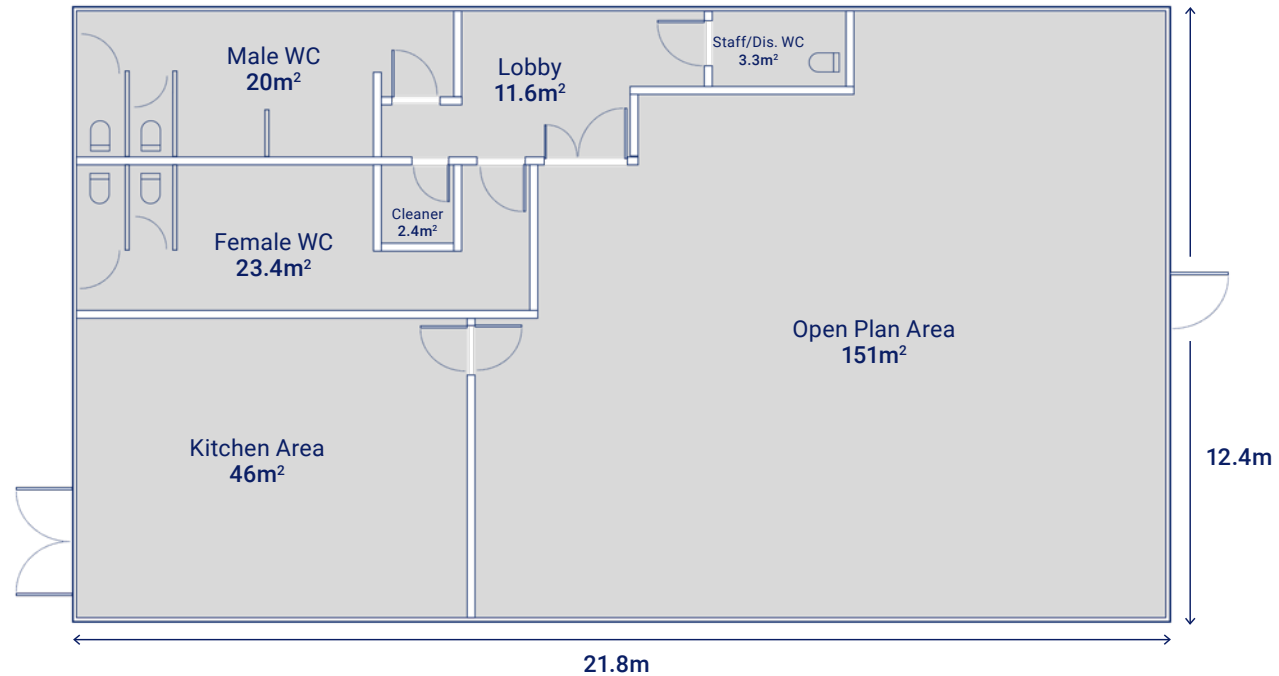

# Two-Storey Office Building

Ref: PCL302

Dimensions: 18m x 9.6m

Number of modules: 12

Overall size: 345.6m<sup>2</sup>

Two-storey office building comprising of open plan offices & ancillary space.

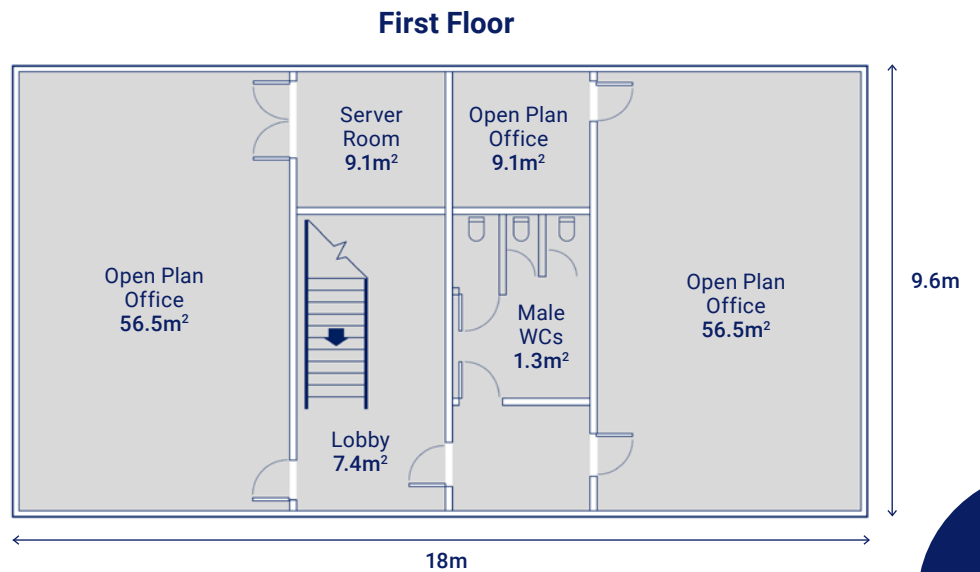
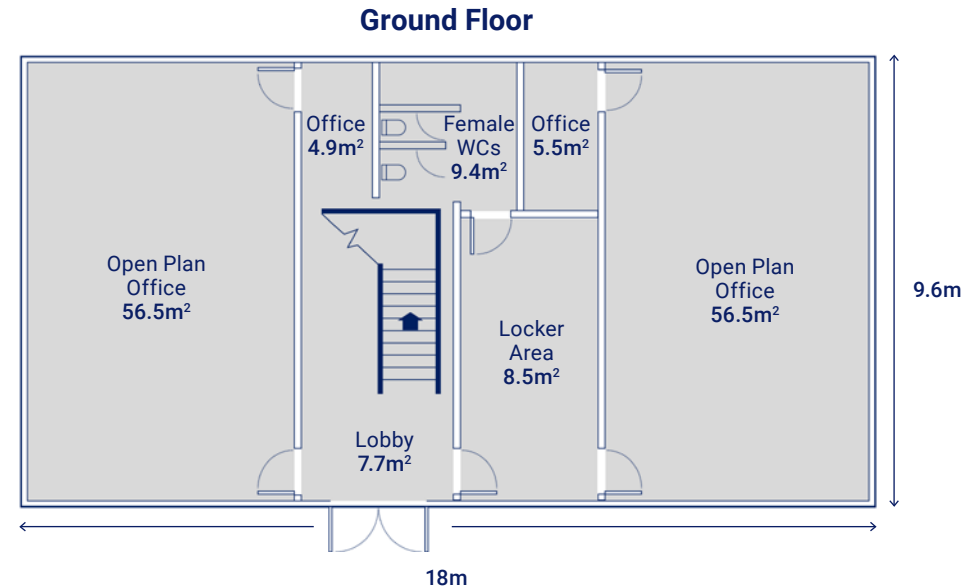

Similar layouts also exist, please ask us for more information.

# Two-Storey Four Office Building with Toilets

Ref: 1296DSFCTD (Office)

Dimensions: 18m x 9.6m

Number of modules: 12

Overall size: 345.6m<sup>2</sup>

Two-storey building comprising of 4 open plan offices with lobby area, store rooms & toilets.

The building has been designed in line with building regulations.



Ground Floor

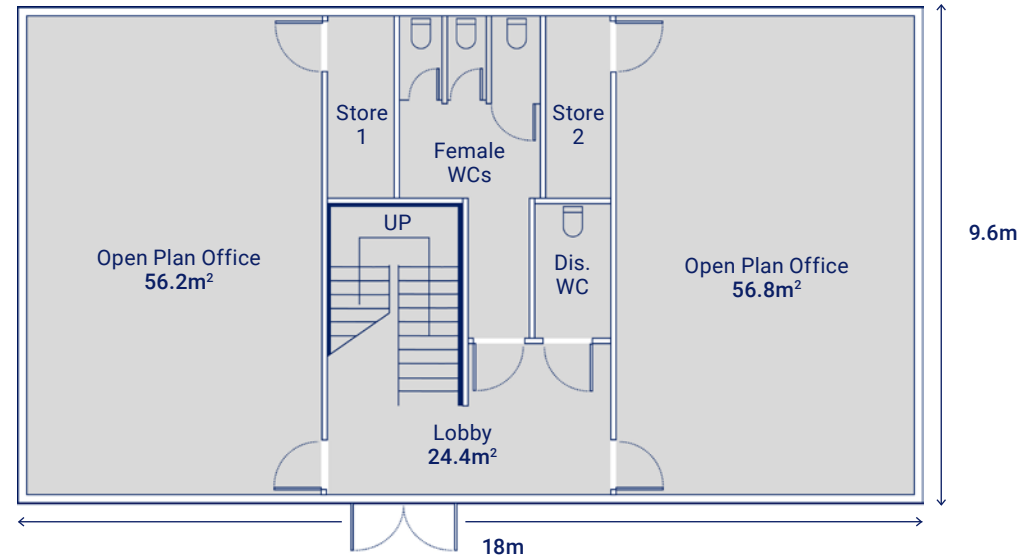

First Floor

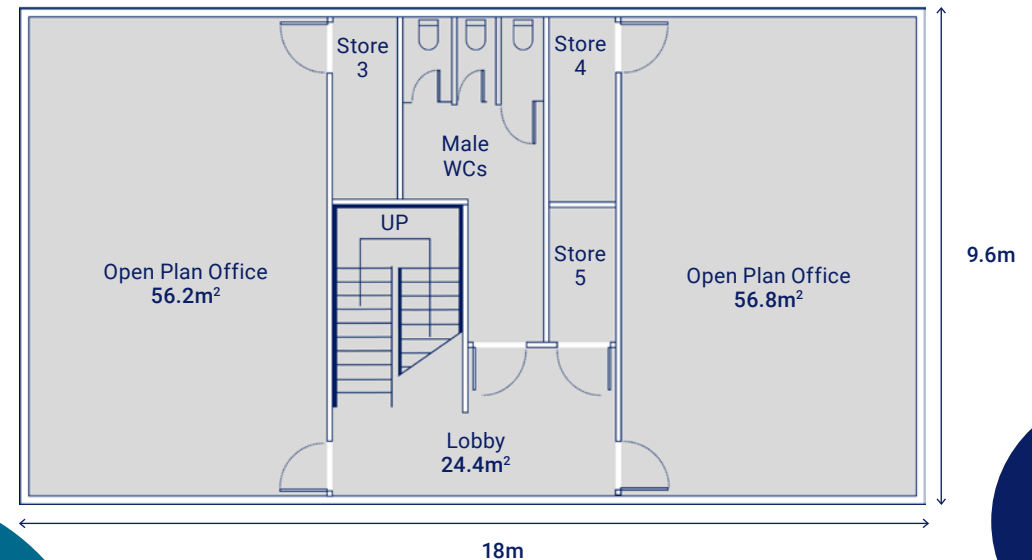

# Office/Welfare Building

Ref: PCL282

Dimensions: 21.7m x 19.2m

Number of modules: 14

Overall size: 416.64m<sup>2</sup>

Single-storey modular building comprising of large, flexible, single-storey space suitable for use as office or welfare facilities.

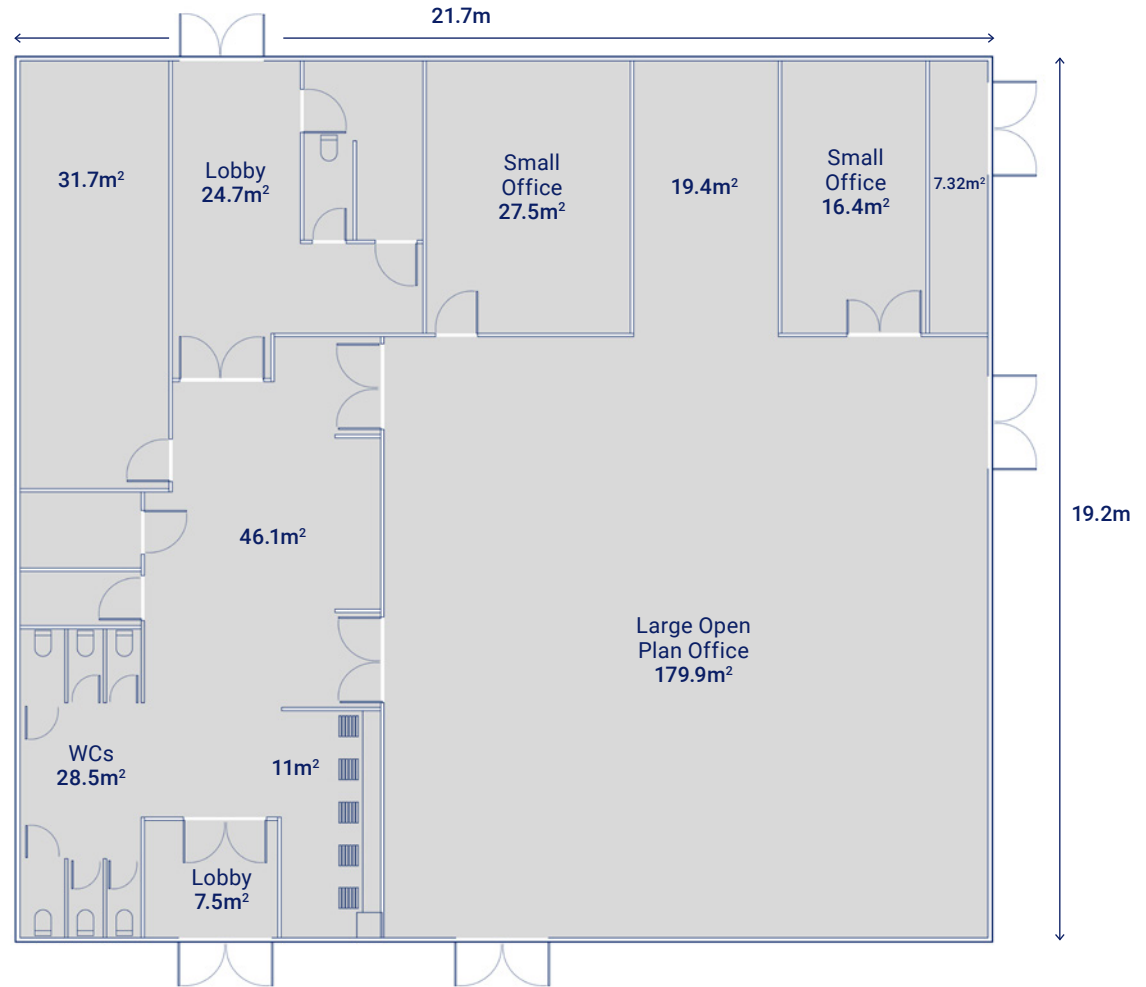

# Classroom Accommodation



# Single-Storey Classroom with toilets

Ref: PCL0334

Dimensions: 9m x 10m

Number of modules: 3

Overall size: 90m<sup>2</sup>

Single storey classroom building with Store room and toilets, including entrance lobby.

The building has been designed in line with building regulations.

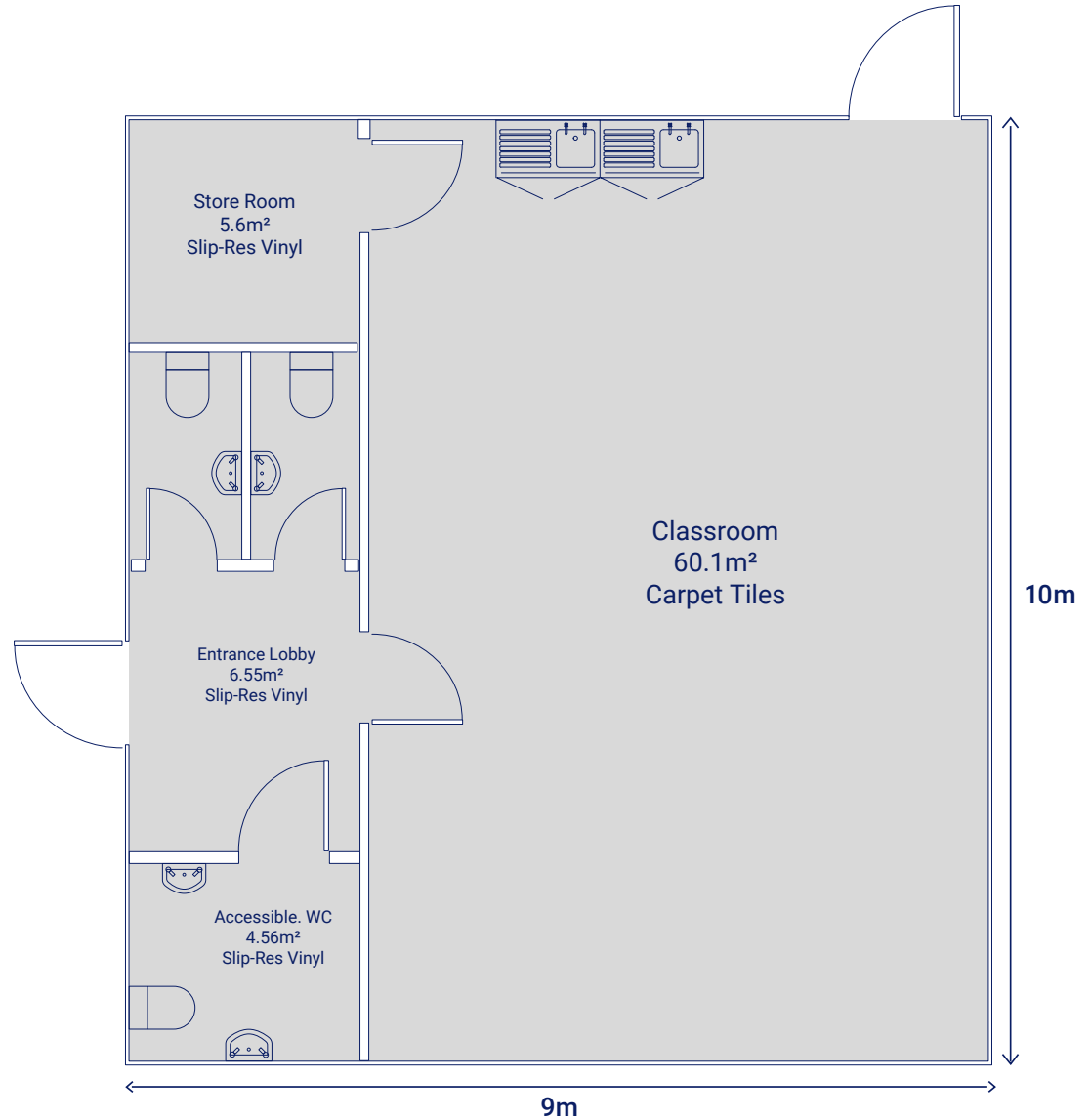

# Single-Storey Two Classroom building with toilets

Ref: SL0113

Dimensions: 18m x 9.6m

Number of modules: 6

Overall size: 173m<sup>2</sup>

Single storey education building comprising 2 classrooms with stores, toilets, and kitchenette.

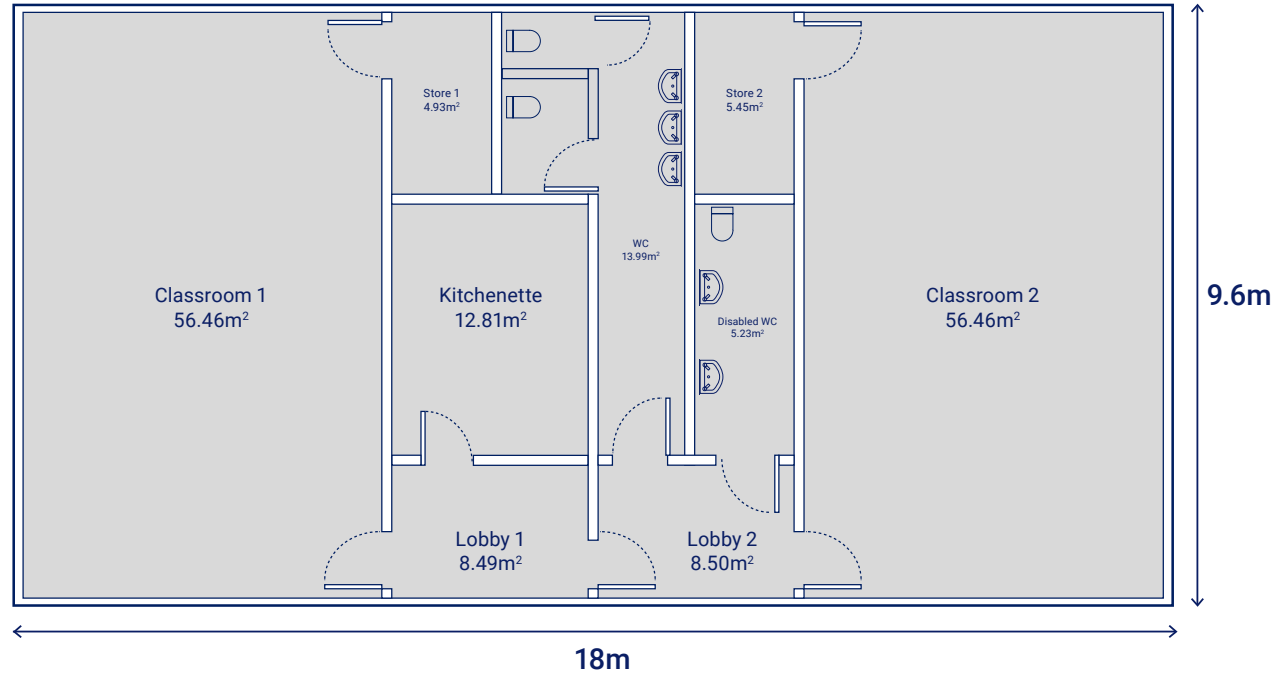

# Single-Storey Two Classroom building with toilets

Ref: PCL0320

Dimensions: 18m x 10m

Number of modules: 6

Overall size: 180m<sup>2</sup>

A single-storey double classroom building with 2 classrooms 62m<sup>2</sup>, 3 WCs, kitchenette and cloak area. This building has been designed to meet current building regulations.

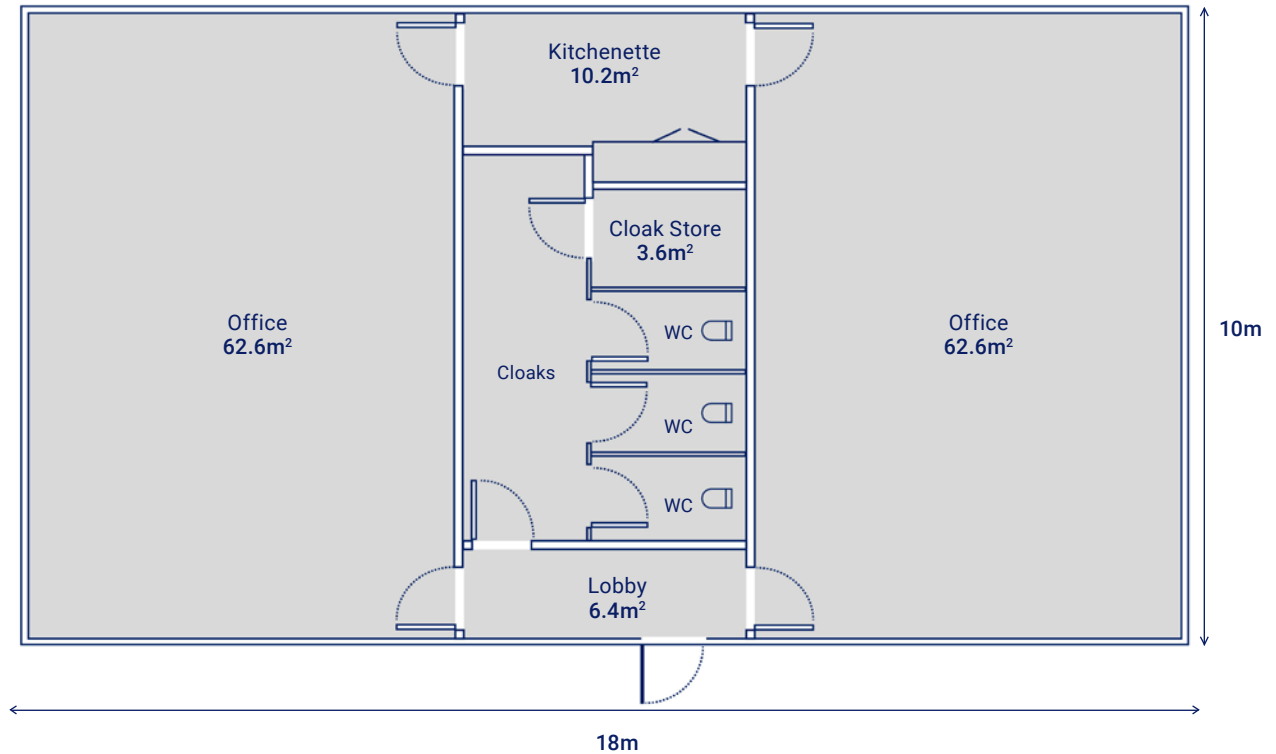

# Single-Storey Two Classroom building with toilets

Ref: PCL0336

Dimensions: 18m x 10m  
Number of modules: 6  
Overall size: 180m<sup>2</sup>

Single storey building with 2 classrooms, changing room, cloakroom, toilets including staff toilets and entrance lobby.

The building has been designed in line with building regulations.

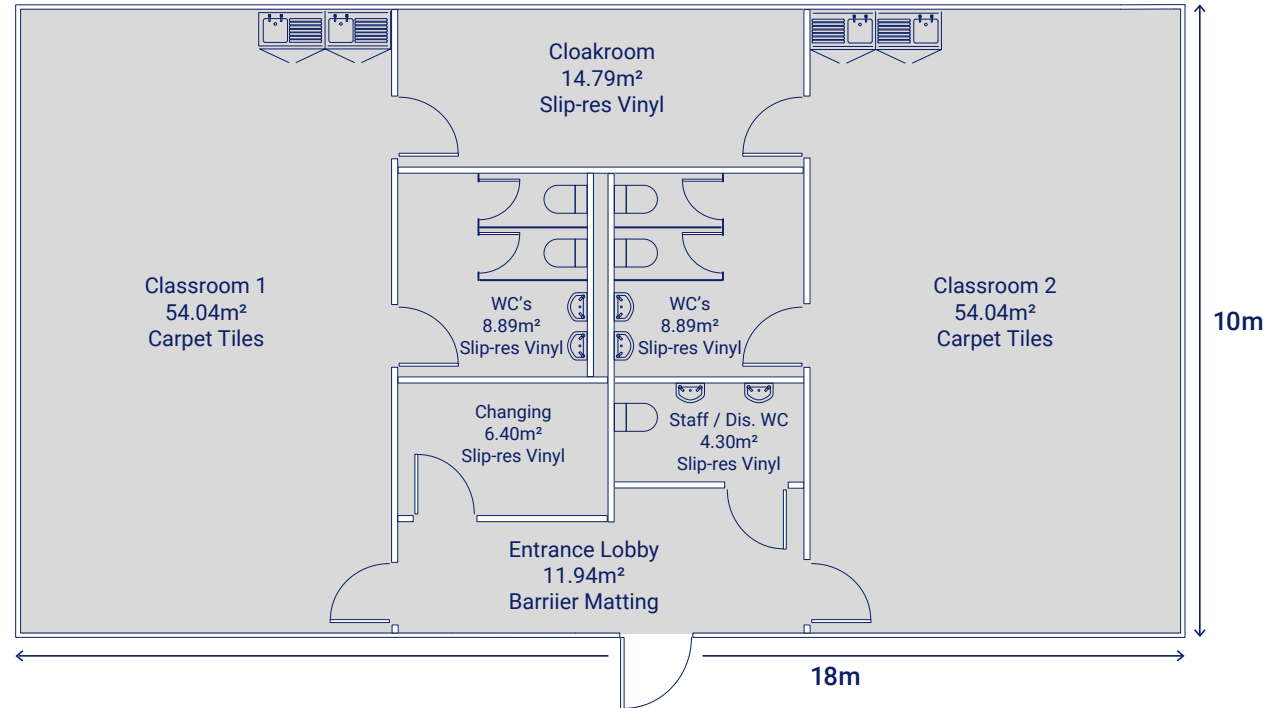

# Single-Storey Two Classroom building with toilets

Ref: PCL0337

Dimensions: 18m x 10m

Number of modules: 6

Overall size: 180m<sup>2</sup>

Single storey building with 2 classrooms, drinks prep area and toilets.

The building has been designed in line with building regulations.

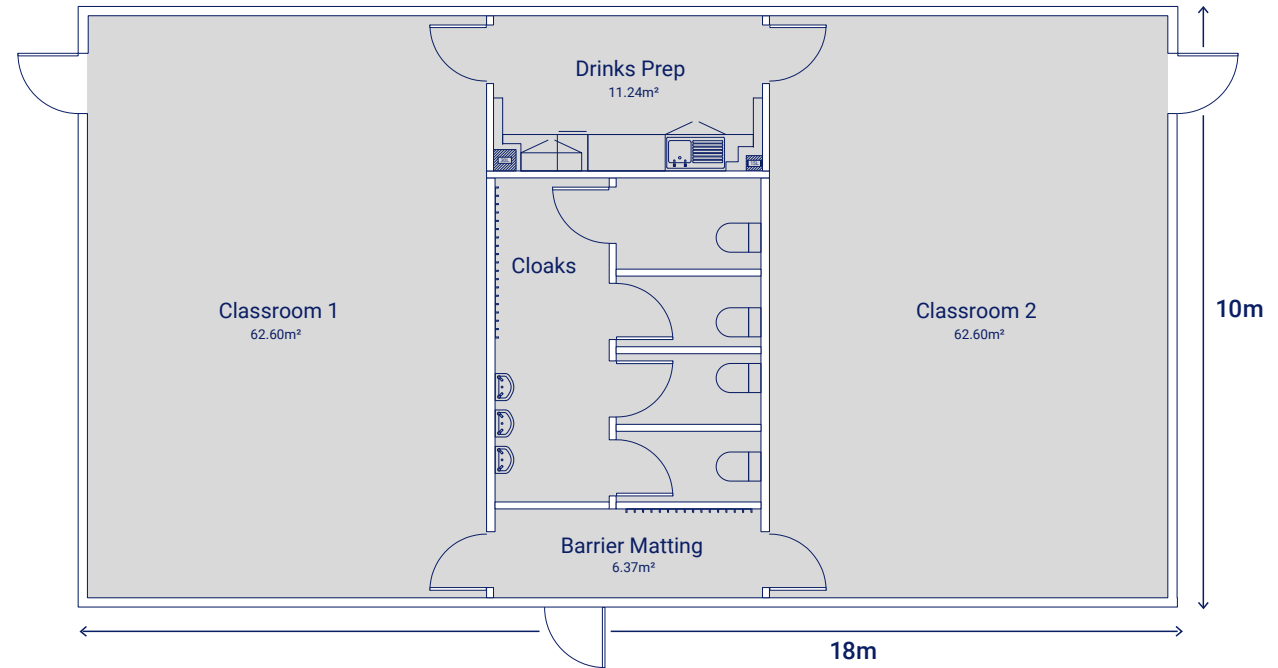

# Two-Storey Classroom Building

Ref: PCL303

Dimensions: 18m x 9.6m  
Number of modules: 12  
Overall size: 345.6m<sup>2</sup>

Two-storey building comprising of classrooms, male & female toilets, stores, locker area and internal stairs.

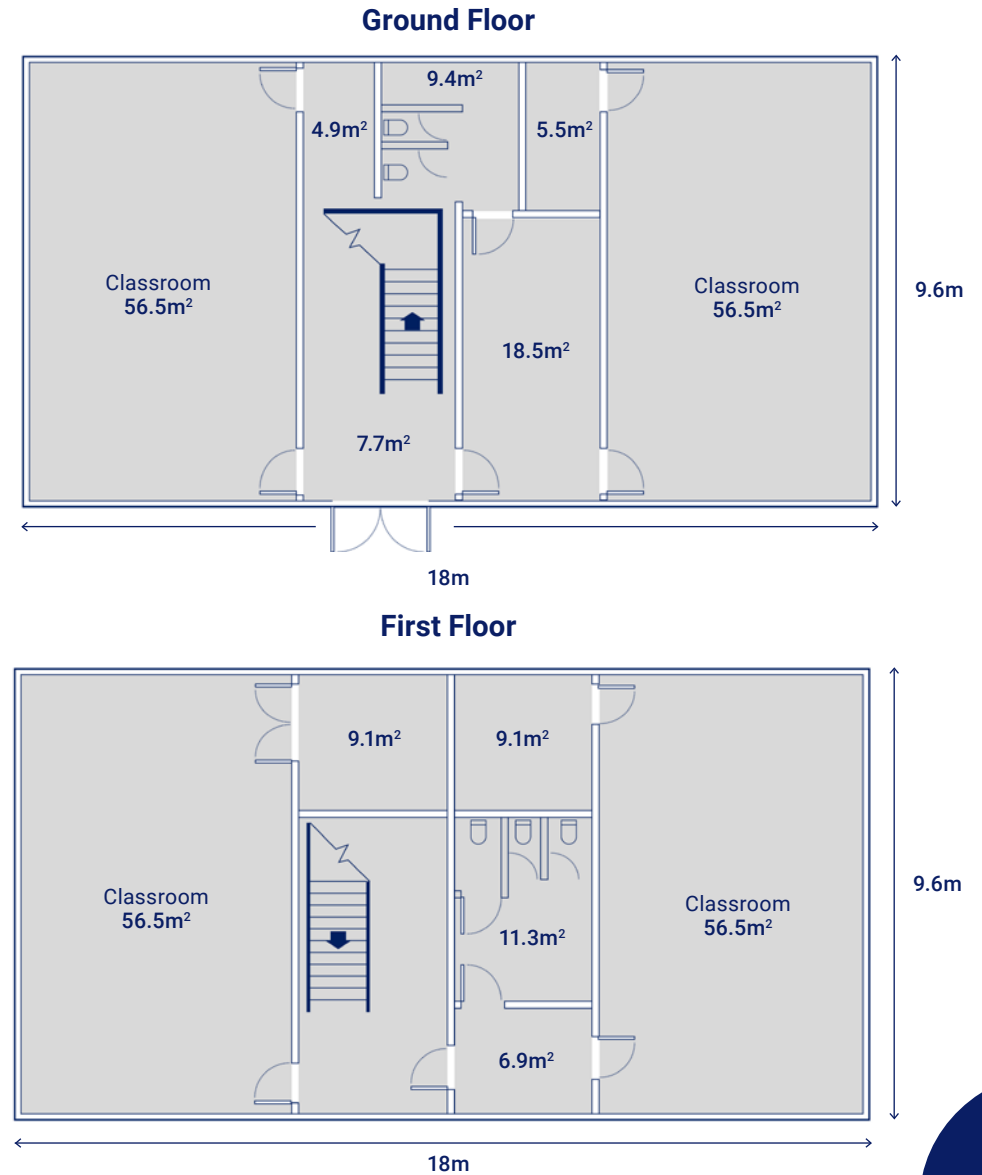

# Two-Storey Four Classroom Building with Toilets

Ref: 1296DSFCTD (Education)

Dimensions: 18m x 9.6m

Number of modules: 12

Overall size: 345.6m<sup>2</sup>

Two-storey building comprising of 4 classrooms with lobby area, store rooms & toilets.

The building has been designed in line with building regulations.

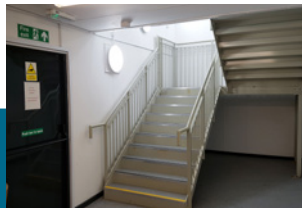

Ground Floor

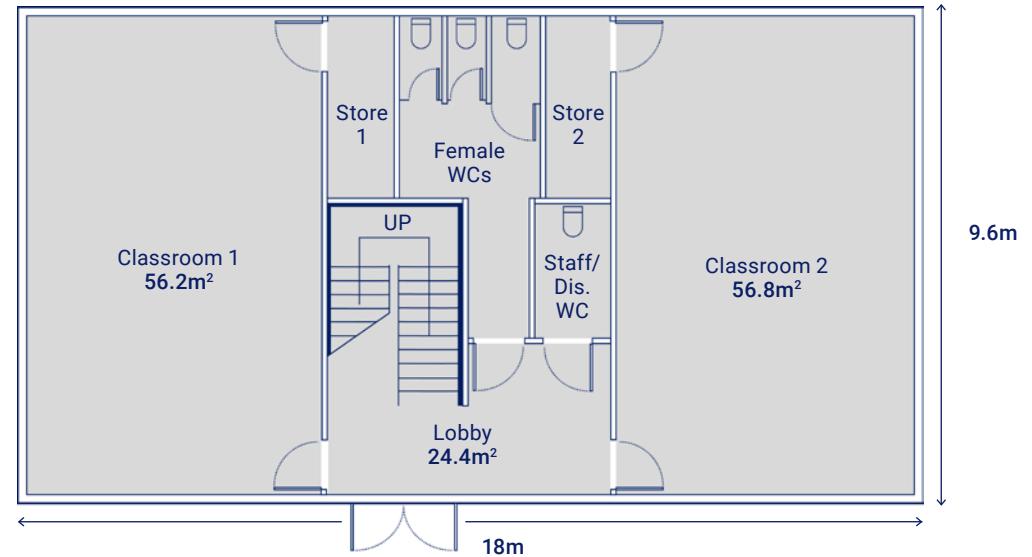

First Floor

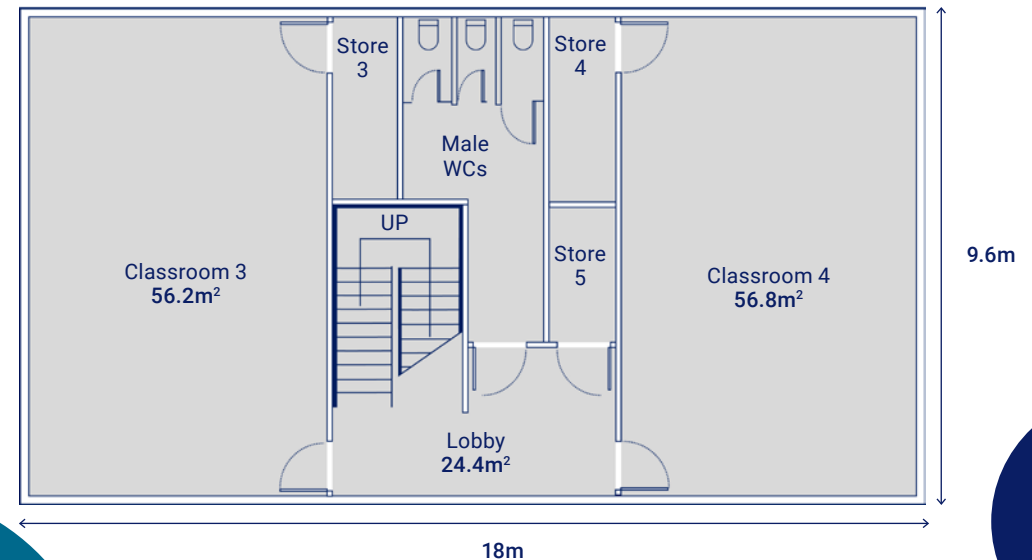

# Two-Storey Four Classroom Building with Toilets

Ref: SL0112

Dimensions: 18m x 9.6m

Number of modules: 12

Overall size: 346m<sup>2</sup>

Double storey education building comprising  
4 classrooms with stores, toilets.

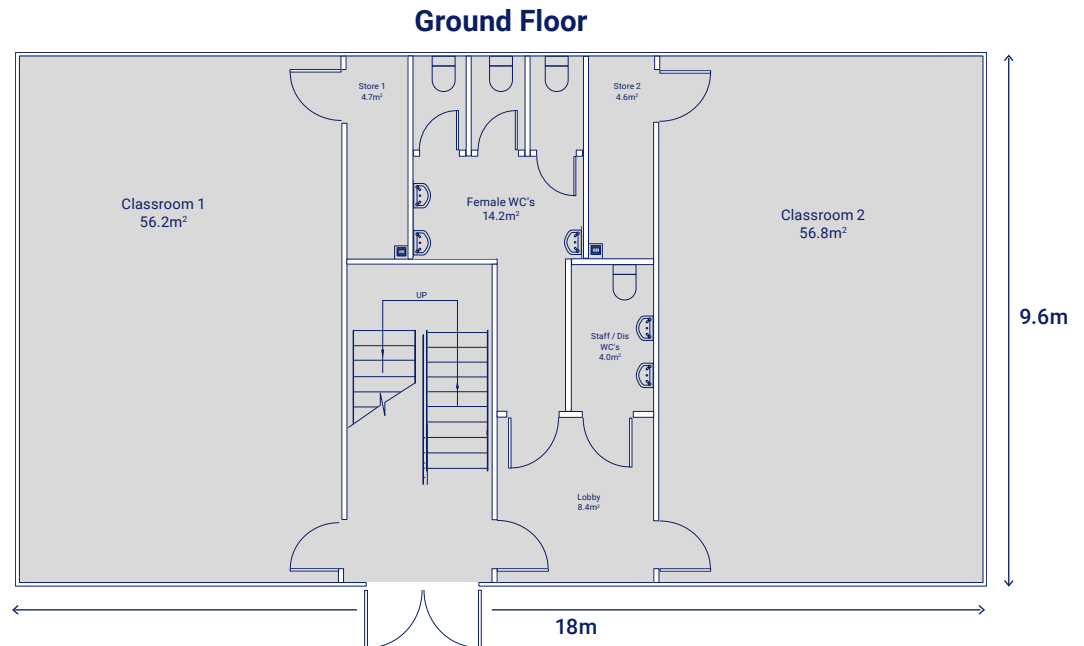
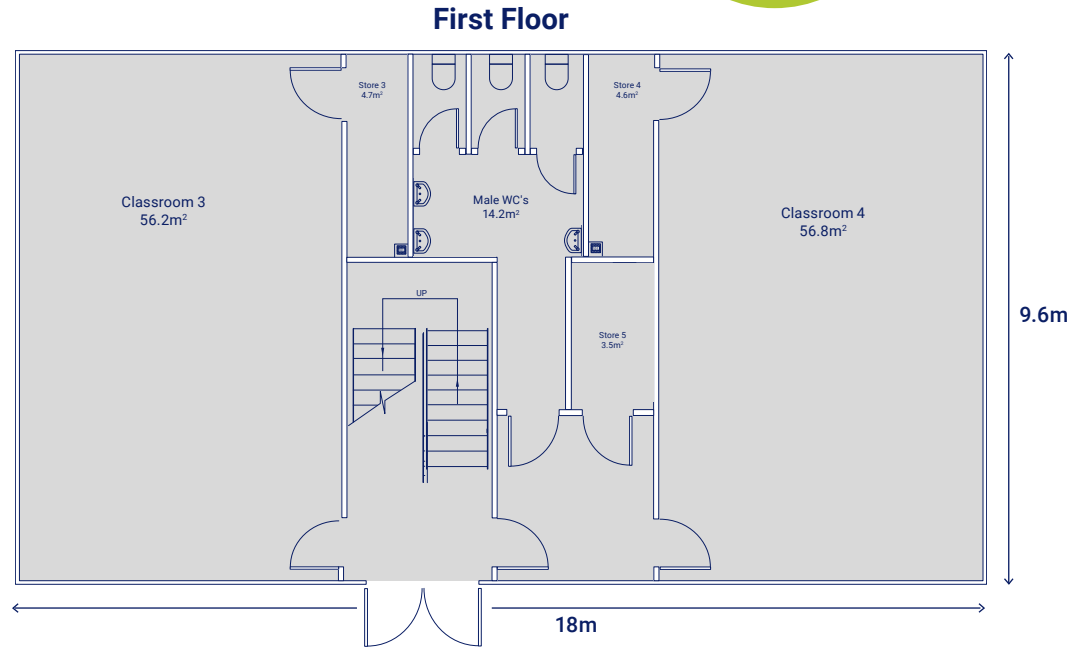

# Single-Storey Hall / Administration

Ref: PCL339

Dimensions: 30m x 12m

Number of modules: 10

Overall size: 360m<sup>2</sup>

Large Single storey education building comprising production kitchen, dining hall space, office spaces and staff room.

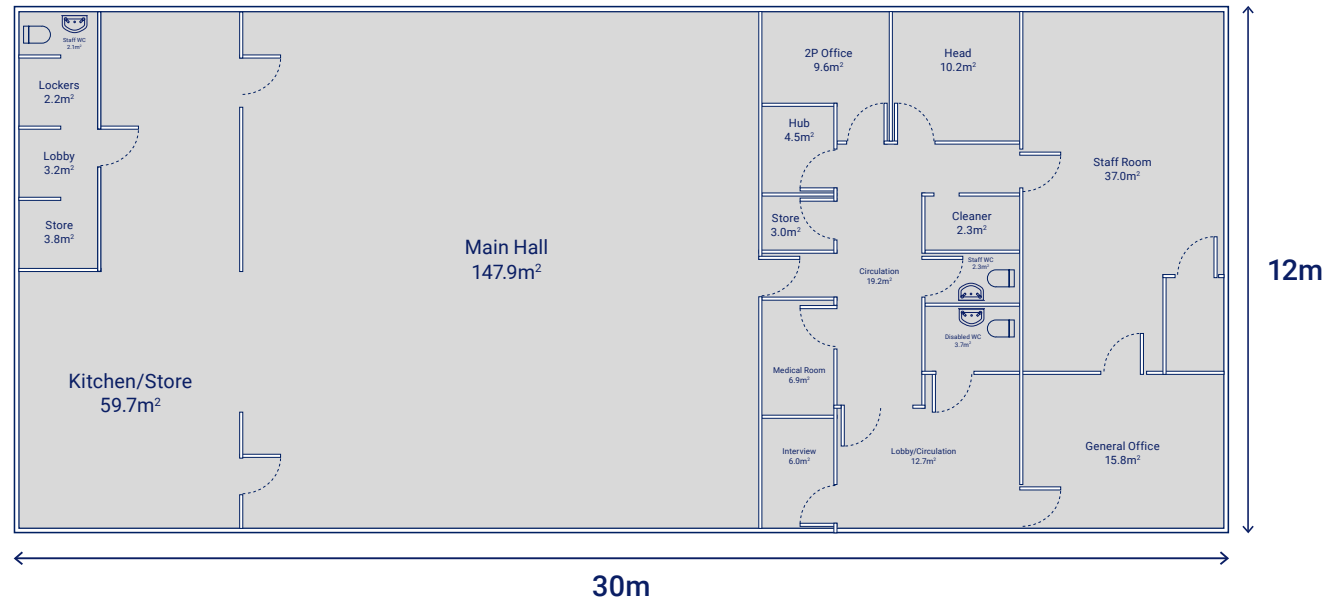

# Two-Storey Classroom Building with Toilets

Ref: SL0106

Dimensions: 18m x 10m

Number of modules: 12

Overall size: 360m<sup>2</sup>

Two-storey building comprising of 4 classrooms, 5 store rooms, male and female toilets including staff toilets and lobby entrance.

The building has been designed in line with building regulations.

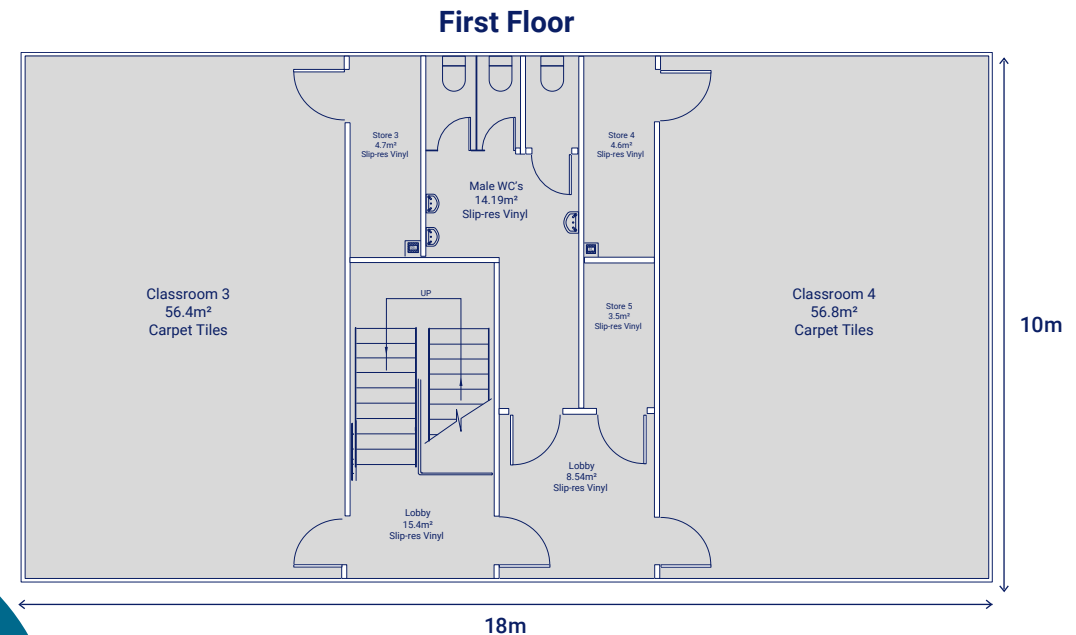
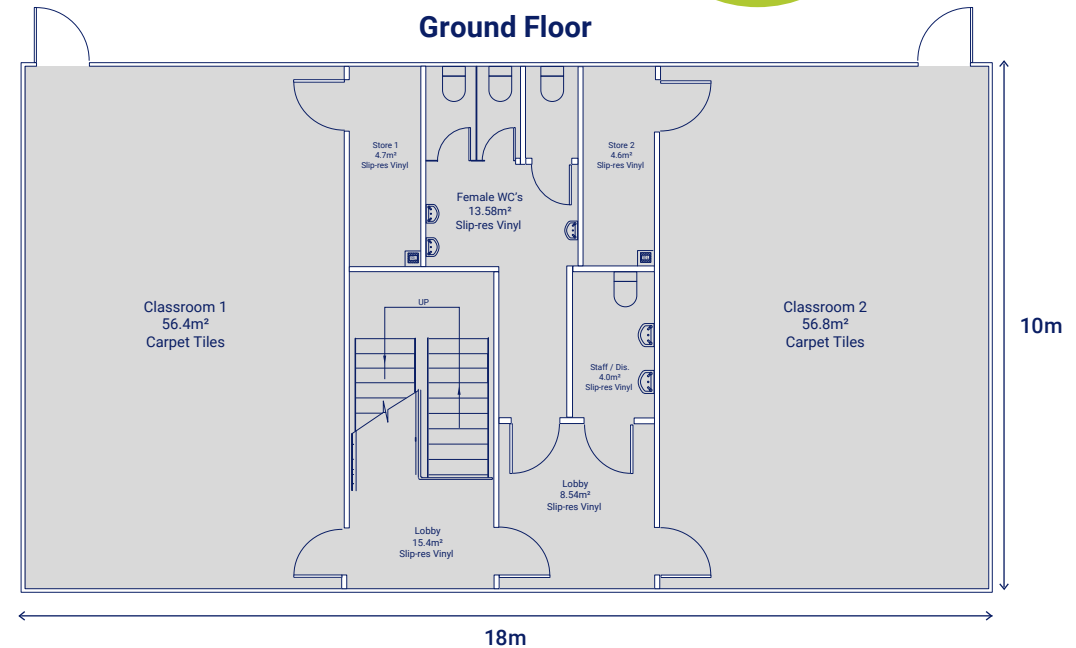

# Two-Storey Classroom Building with Toilets

Ref: SL0111

Dimensions: 18m x 10m  
Number of modules: 12  
Overall size: 360m<sup>2</sup>

Two-storey building comprising of 4 classrooms, 5 store rooms, male and female toilets including staff toilets and lobby entrance.

The building has been designed in line with building regulations.



Ground Floor

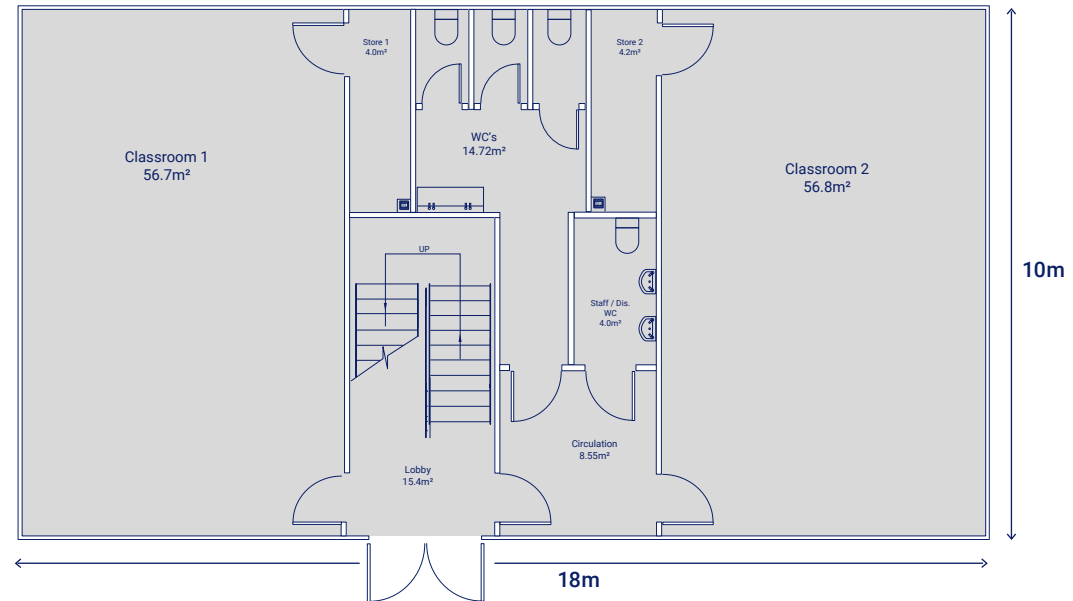

First Floor

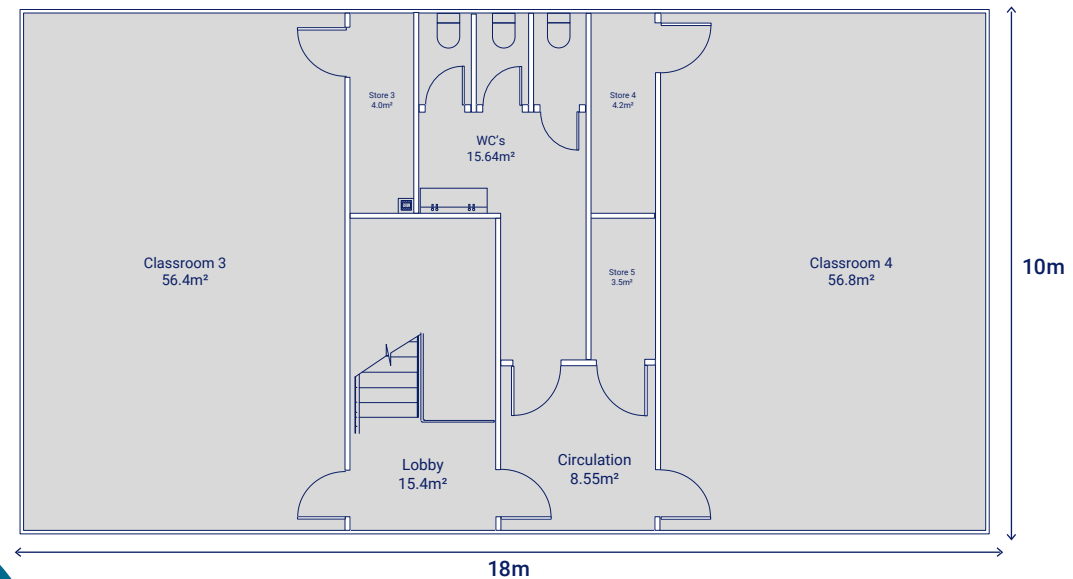

# Two-Storey Classroom Building with Toilets

Ref: SL0095

Dimensions: 28m x 12m

Number of modules: 18

Overall size: 672m<sup>2</sup>

Two-storey building comprising of 5 classrooms, 3 ICT classrooms with ICT office, male & female toilets, office, store room.

The building has been designed in line with building regulations.



Ground Floor

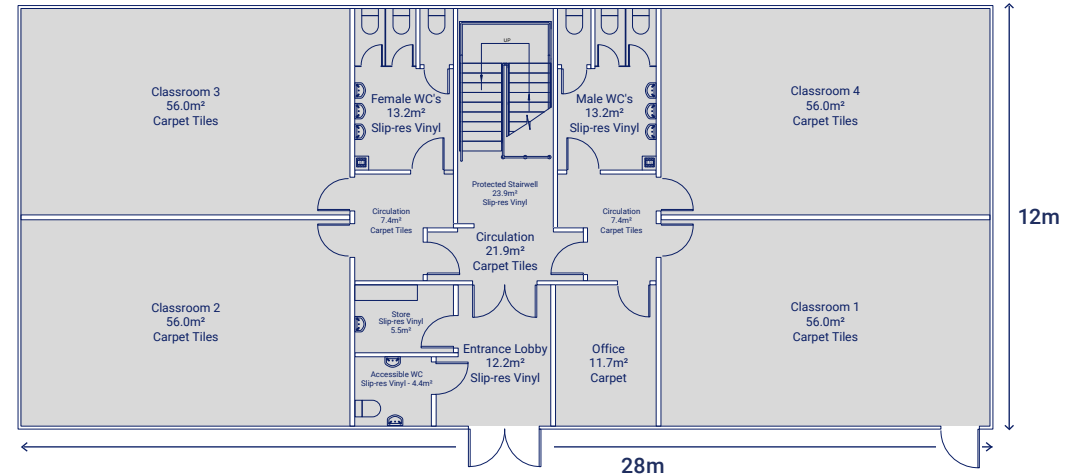

First Floor

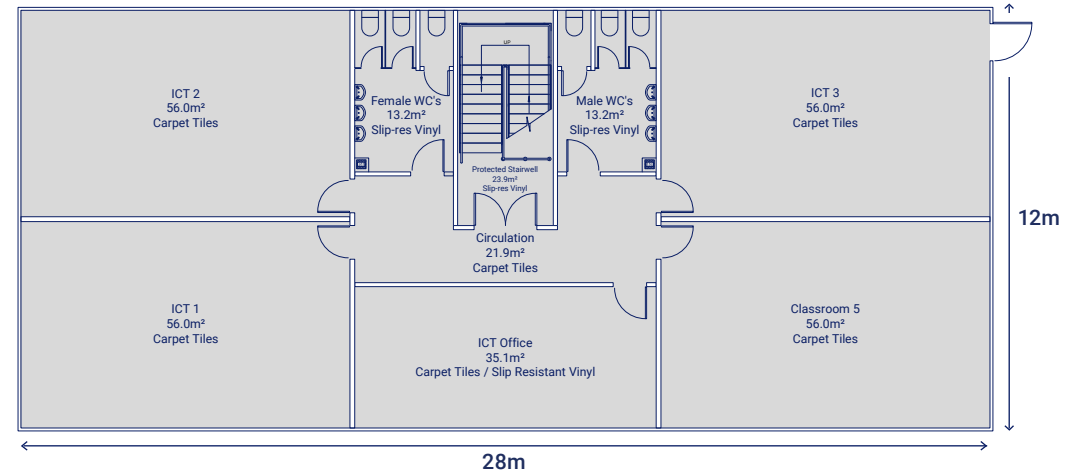

# Large Eight Classroom Block

Ref: PCL340

Dimensions: 36m x 12m

Number of modules: 24

Overall size: 864m<sup>2</sup>

Large double storey education building comprising 5 standard classrooms, art room, 2 science classrooms, toilets, and office spaces.



First Floor

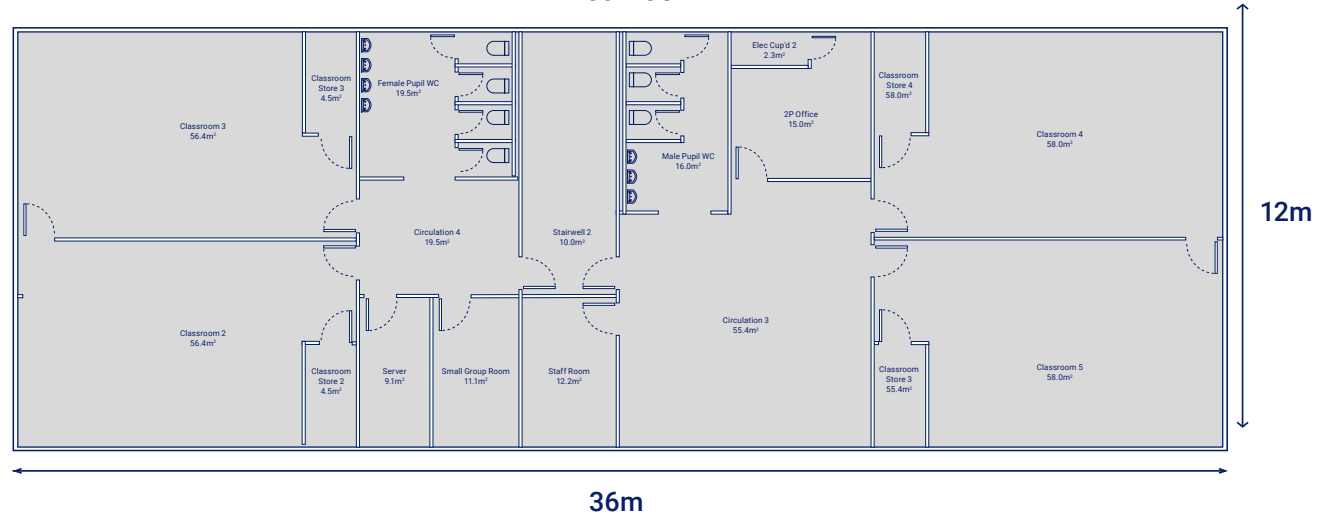

Ground Floor

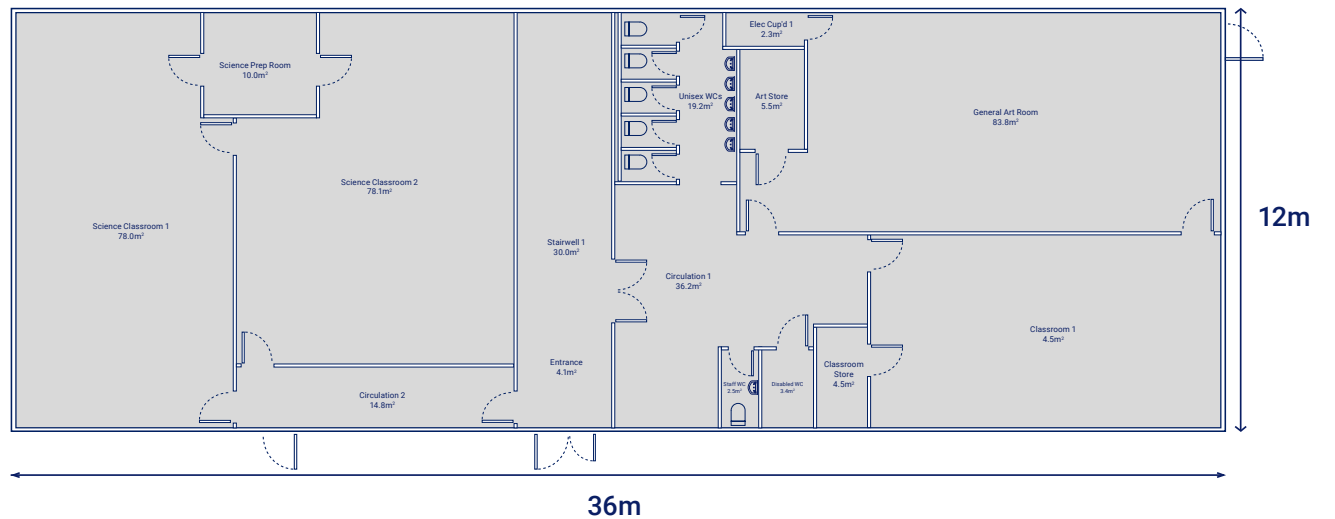

# Two-Story Classroom Block

Ref: PCL341

Dimensions: 30m x 12m

Number of modules: 20

Overall size: 720m<sup>2</sup>

Large double storey education building comprising 8 classrooms, toilets, staff room and office spaces.



First Floor

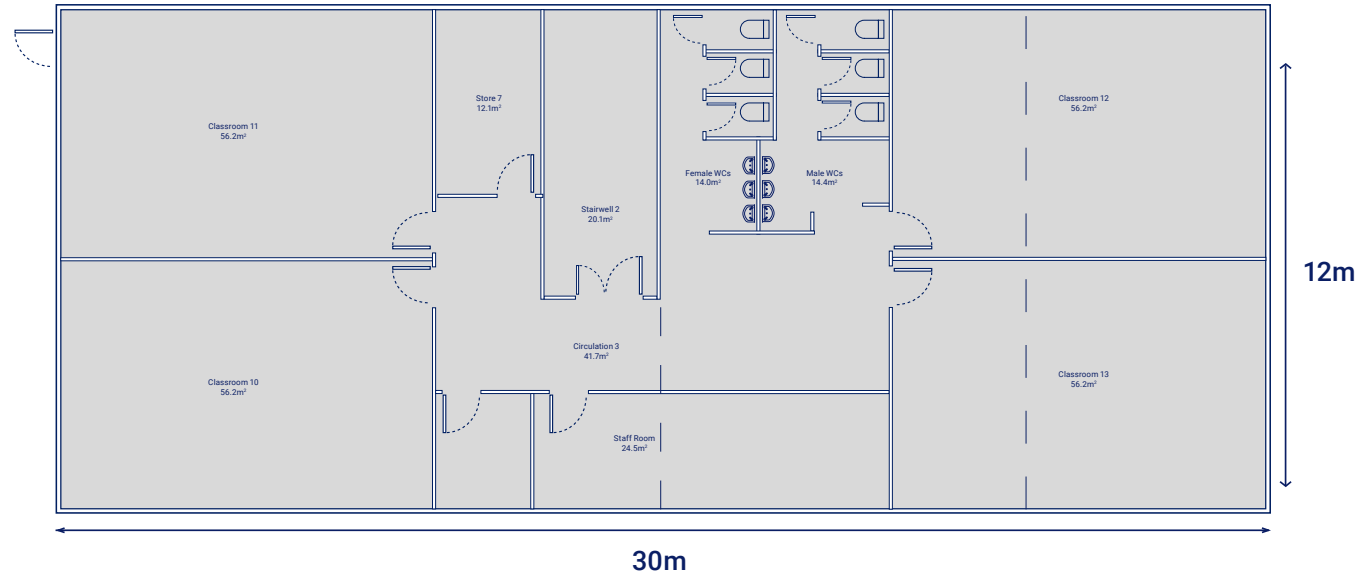

Ground Floor

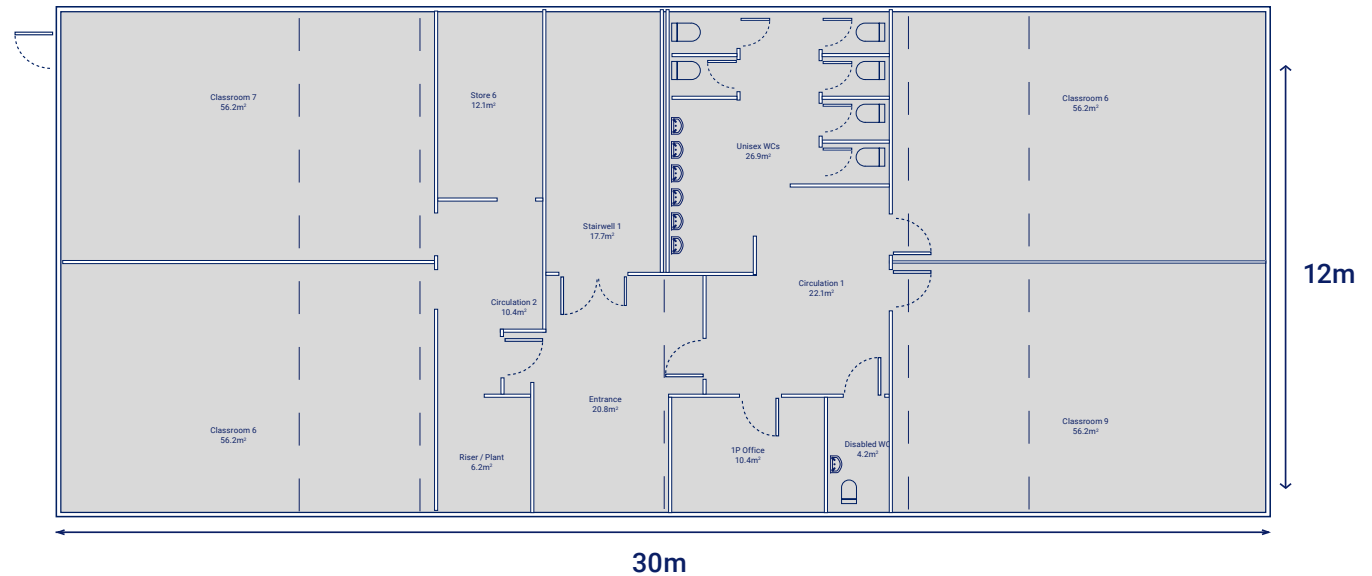

# Three-Storey Science Building with Toilets

Ref: PCL0330

Dimensions: 24.4m x 18m

Number of modules: 36

Overall size: 1,317.6m<sup>2</sup>

Three-storey science building comprising of 8 science labs, 2 classrooms, 3 prep areas, office and toilet facilities.

The building has been designed in line with building regulations.

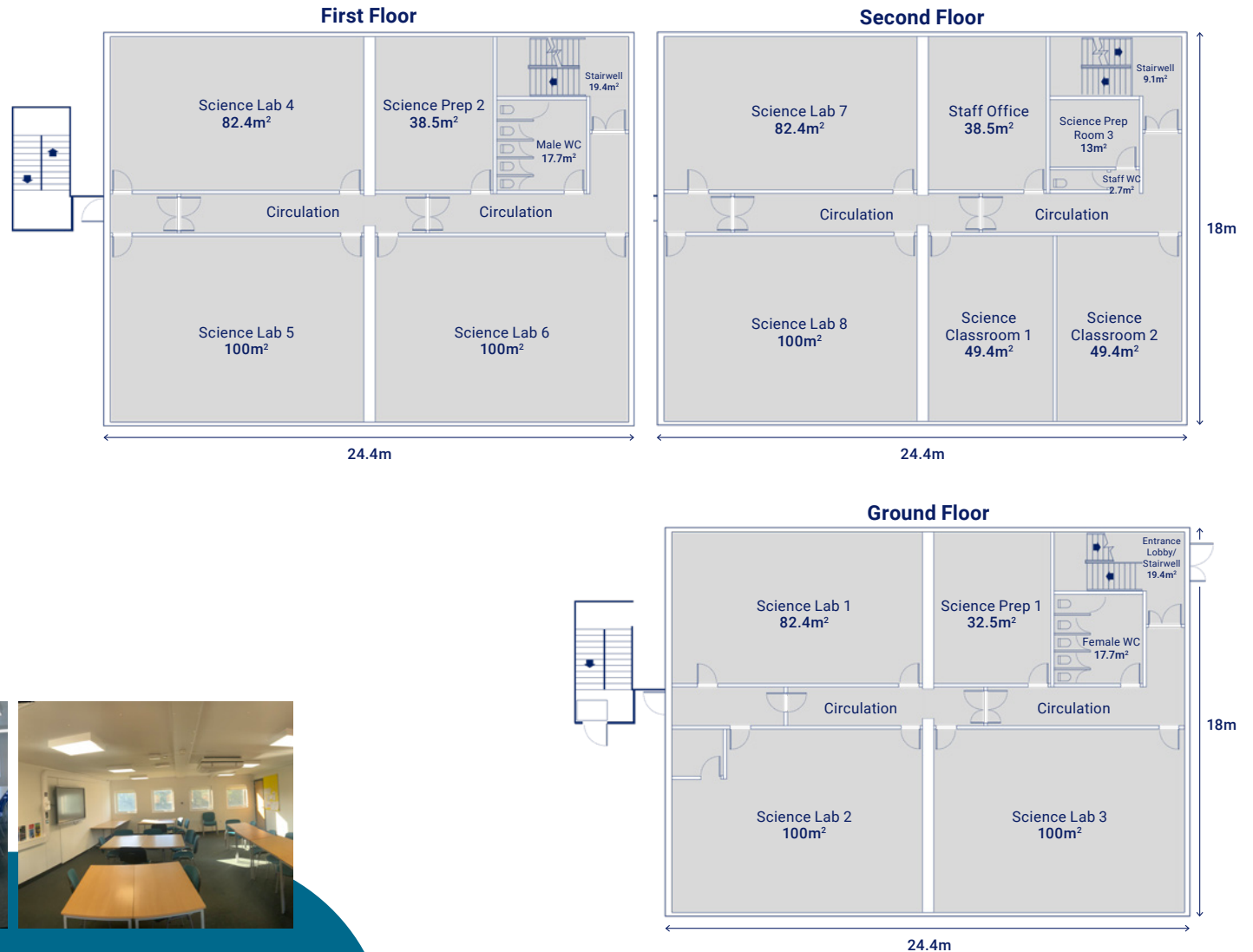

# Large Two-Storey Education Building

Ref: PCL256

Dimensions: 49.8m x 19.2m  
Number of modules: 64  
Overall size: 1,910m<sup>2</sup>

Large two-storey education building comprising of classrooms, dining area, specialist teaching & ancillary space.

The building has been designed in line with building regulations.

Ground Floor

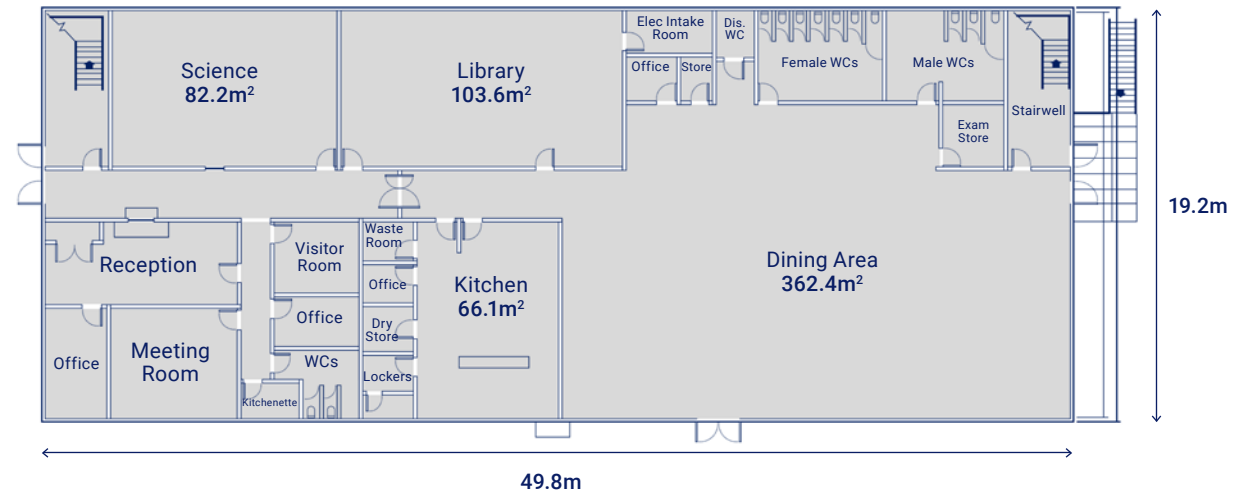

First Floor

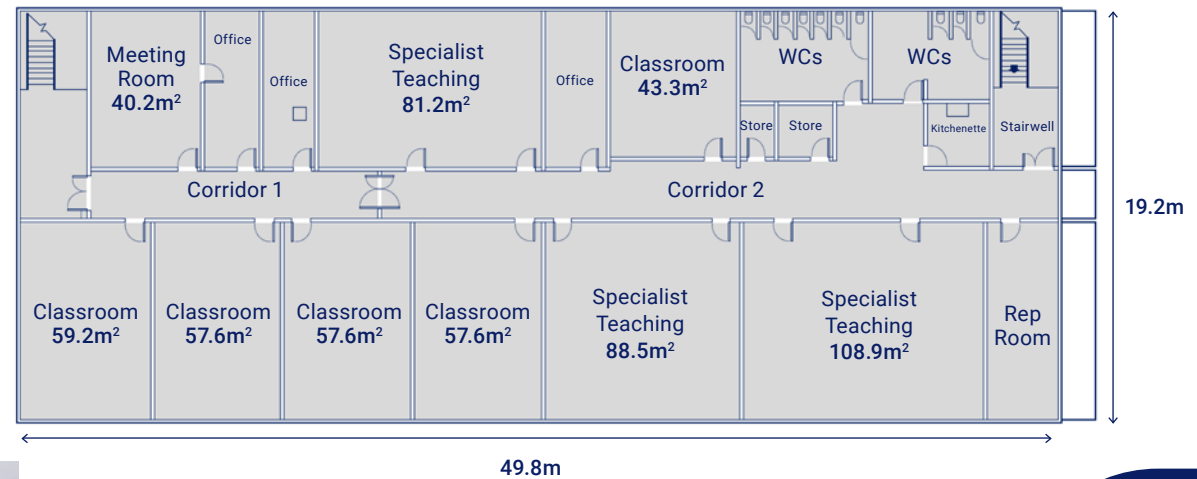

# Large Primary School Building

Ref: PCL0318

Dimensions: 77.8m x 19.9m

Number of modules: 100

Overall size: 3,096m<sup>2</sup>

Large two-storey primary school previously hired to support a DfE decant education project for a 2½ year hire.

Layout includes reception classrooms (x4), nursery, SEN rooms, classrooms Yrs. 1-4, primary toilets and staff facilities.

Ground Floor

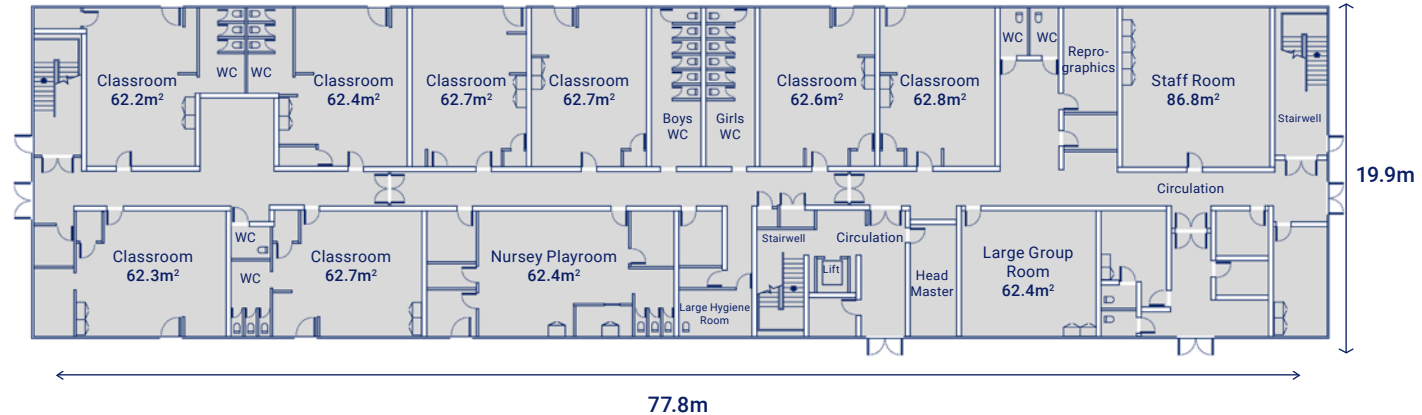

First Floor

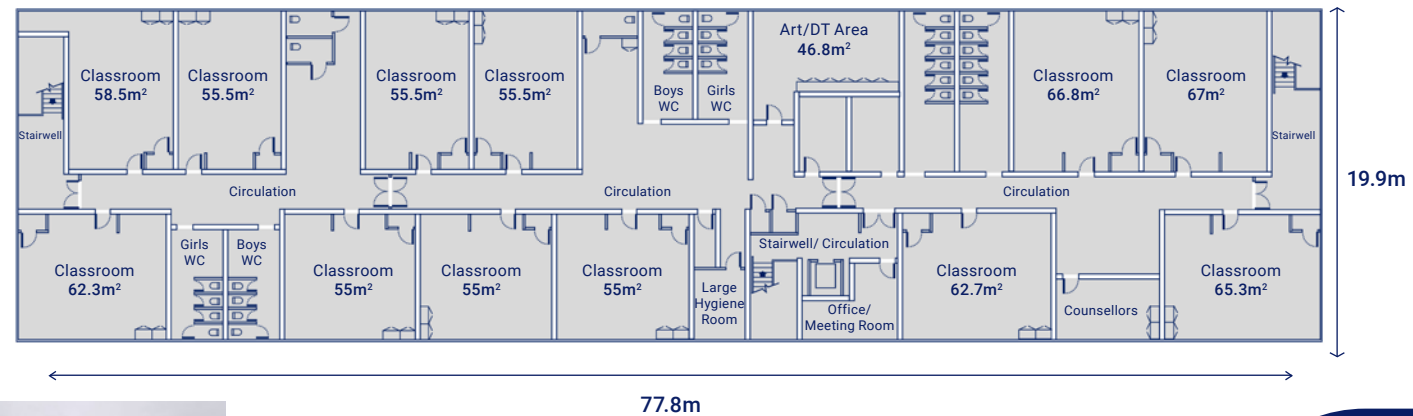



34 / Available Rental

# Sustainability

At Algeco, ESG and Sustainability (ESGS) is integrated into all aspects of our business. We measure and communicate ESGs against three external global standards – the United Nations’ Sustainable Development Goals (17 SDGs), the United Nations Global Compact’s principles (UNGC), and the Task Force on Climate-related Financial Disclosures (TCFD).





# Secure your building now

Call our building experts

● Callum Beaver,  
Business Development Manager  
Midlands & Northwest

☎ 07976 521 516

✉ callum.beaver@algeco.com

● Zoe Sparkes  
Business Development Manager

☎ 07827 906457

✉ zoe.sparkes@algeco.com

[VIEW RECENT CASE STUDIES](#)

As part of our commitment to sustainability, this is a digitally-designed brochure. Please consider if you need to print it. Thank you.

